

### THREADED FLANGE KIT with screws and gasket

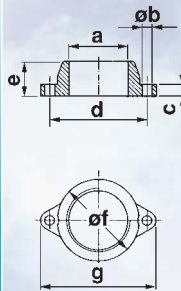

Suitable for	Item	a	b	c	d	e	f	g
UNI-JET 40	169752	1"	6	8	54	25	52	74
UNI-JET 75	169750	1 1/4"	6,5	8	64	23	54	76
FLUX-JET	169770	1 1/2"	8,5	8	83	23	62	98
	169751	2"	8,5	8	83	23	72	98
MEDIO-JET	169751	2"	8,5	8	83	23	72	98
UNI-JET 75 2V	169750	1 1/4"	6,5	8	64	23	54	76
FLUX-JET 2V	169770	1 1/2"	8,5	8	83	23	62	98
	169751	2"	8,5	8	83	23	72	98
MEDIO-JET 2V	169751	2"	8,5	8	83	23	72	98
MEDIO-JET 1AC	169751	2"	8,5	8	83	23	72	98

### DOUBLE ENDED SUPPLEMENTARY SILENCER

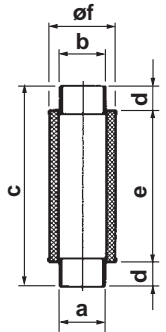

### ONE ENDED SUPPLEMENTARY SILENCER

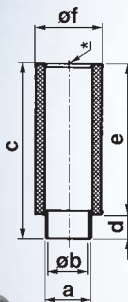

Suitable for	Item	a	b	c	d	e	f	Net
UNI-JET 75	169369	1 1/4"	37	190	52	138	70	
TECNO-JET	169370	1 1/2"	42	200	32	168	80	
FLUX-JET	169370	1 1/2"	42	200	32	168	80	
MEDIO-JET	169371	2"	53	230	32	198	90	
	169372	2"	53	230	32	198	90	*
UNI-JET 75 2V	169369	1 1/4"	37	190	52	138	70	
TECNO-JET 2V	169370	1 1/2"	42	200	32	168	80	
FLUX-JET 2V	169370	1 1/2"	42	200	32	168	80	
MEDIO-JET 2V	169371	2"	53	230	32	198	90	
	169372	2"	53	230	32	198	90	*
	169368	3"	80	435	85	350	152	*

Suitable for	Item	a	b	c	d	e	f
UNI-JET 75	169374	1 1/4"	1 1/4"	240	52	136	70
TECNO-JET	169375	1 1/2"	1 1/2"	233	32	169	80
FLUX-JET	169375	1 1/2"	1 1/2"	233	32	169	80
MEDIO-JET	169373	2"	2"	260	32	196	90
UNI-JET 75 2V	169374	1 1/4"	1 1/4"	240	52	136	70
TECNO-JET 2V	169375	1 1/2"	1 1/2"	233	32	169	80
FLUX-JET 2V	169375	1 1/2"	1 1/2"	233	32	169	80
MEDIO-JET 2V	169373	2"	2"	260	32	196	90
UNI-JET 500	169376	2 1/2"	2 1/2"	262	32	198	100
UNI-JET 1000	169377	4"	4"	570	40	400	152

### INLET FILTER

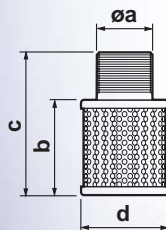

Suitable for	Item	a	b	c	d
MICRO-JET	168551	1/4"	52	66	43
UNI-JET 40	168554	1"	62	82	69
UNI-JET 75	168550	1 1/4"	62	113	69
TECNO-JET	168553	1 1/2"	81	113	80
FLUX-JET	168553	1 1/2"	81	113	80
	168555	2"	134	164	89
MEDIO-JET	168555	2"	134	164	89
UNI-JET 75 2V	168550	1 1/4"	62	113	69
TECNO-JET 2V	168553	1 1/2"	81	113	80
FLUX-JET 2V	168553	1 1/2"	81	113	80
	168555	2"	134	164	89
MEDIO-JET 2V	168555	2"	134	164	89

### TUBEHOLDER FLANGE KIT with screws and gasket

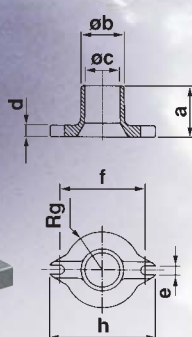

Suitable for	Item	a	b	c	d	e	f	g	h
UNI-JET 40	169766	36	30	25	5	ø6,5	54	27	76
UNI-JET 75	169760	36	30	25	5	ø6,5	64	27	76
	169761	50	38	34	5	6	60	26	74
	169762	50	40	34	5	6	60	26	74
FLUX-JET	169764	120	40	38	8	ø8,5	83	31	98
	169763	120	50	48	8	ø8,5	83	36	98
	169767	48	60	52	8	ø8	83	36	97
MEDIO-JET	169767	48	60	52	8	ø8	83	36	97
UNI-JET 75 2V	169760	36	30	25	5	ø6,5	64	27	76
	169761	50	38	34	5	6	60	26	74
	169762	50	40	34	5	6	60	26	74
FLUX-JET 2V	169763	120	50	48	8	ø8,5	83	36	98
	169764	120	40	38	8	ø8,5	83	31	98
	169767	48	60	52	8	ø8	83	36	97
MEDIO-JET 2V	169767	48	60	52	8	ø8	83	36	97
MEDIO-JET 1AC	169767	48	60	52	8	ø8	83	36	97

The accessories at your disposal have been specially designed to facilitate the installation of the side channel blowers/aspirators. Some of these accessories, such as filters and vacuum/pressure relief valves, are essential for ensuring the correct operation of the blowers/aspirators.

In addition to these accessories for our side channel blowers/aspirators, Esam also offers a wide range of components for custom designed centralised vacuum cleaning systems. Please ask for our separate product catalogue for these components.

# ACCESSORIES



## VACUUM FILTER

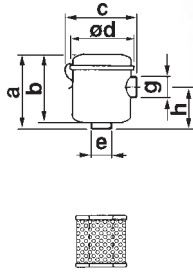

Suitable for	Item	a	b	c	d	e	g	h	Replacement cartridge code
UNI-JET 75	168560	161	156	200	176	1 1/4"	1 1/4"	93,5	167671
TECNO-JET	168564	192	185	200	176	1 1/2"	1 1/2"	111,5	167673
FLUX-JET	168564	192	185	200	176	1 1/2"	1 1/2"	111,5	167673
	168561	258	211	226	200	2"	2"	153,5	167672
MEDIO-JET	168561	258	211	226	200	2"	2"	153,5	167672
UNI-JET 75 2V	168560	161	156	200	176	1 1/4"	1 1/4"	93,5	167671
TECNO-JET 2V	168564	192	185	200	176	1 1/2"	1 1/2"	111,5	167673
FLUX-JET 2V	168564	192	185	200	176	1 1/2"	1 1/2"	111,5	167673
	168561	258	211	226	200	2"	2"	153,5	167672
MEDIO-JET 2V	168561	258	211	226	200	2"	2"	153,5	167672
UNI-JET 500/2V	168543	258	211	226	200	2 1/2"	2 1/2"	153,5	167672
UNI-JET 1000/2V	168544	320			305	4"	4"		167679

## VACUUM RELIEF VALVE

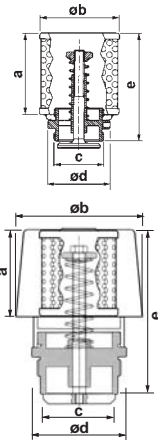

Suitable for	Item	a	b	c	d	e
TECNO-JET/2V	169835	80	80	1 1/2"	CH55	100
FLUX-JET/2V	169835	80	80	1 1/2"	CH55	100
UNI-JET 75/2V	169835	80	80	1 1/2"	CH55	100
UNI-JET 160	169849	80	80	1 1/2"	CH55	100
MEDIO-JET/2V	169846	134	89	2"	CH65	165

Suitable for	Item	a	b	c	d	e
MEDIO-JET 1AC	169844	160	195	3"	CH100	300
UNI-JET 500/2V	169844	160	195	3"	CH100	300
UNI-JET 1000/2V	169844	160	195	3"	CH100	300

## PRESSURE RELIEF VALVE

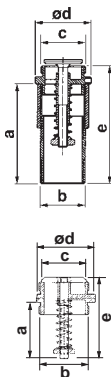

Suitable for	Item	a	b	c	d	e
TECNO-JET/2V	169834	110	1 1/2"	1 1/2"	CH 55	135
FLUX-JET/2V	169834	110	1 1/2"	1 1/2"	CH 55	135
UNI-JET 75 2V	169834	110	1 1/2"	1 1/2"	CH 55	135
UNI-JET 160	169856	110	1 1/2"	1 1/2"	CH 55	135
MEDIO-JET 1AC	169857	64	3" F	3" F	CH 100	165
UNI-JET 500/2V	169857	64	3" F	3" F	CH 100	165
UNI-JET 1000/2V	169857	64	3" F	3" F	CH 100	165

Suitable for	Item	a	b	c	d	e
MEDIO-JET/ 2V	169858	110	2"	2"	CH 65	—

## AIR REVERSAL VALVE



Suitable for	Item
FLUX-JET	169811
MEDIO-JET	169811
FLUX-JET 2V	169811
MEDIO-JET 2V	169811

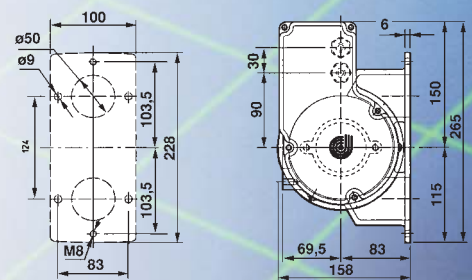
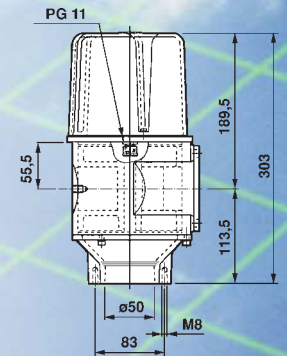
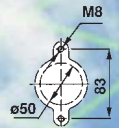

## CARTRIDGE SUCTION FILTER with replacement cartridges in paper or polyester

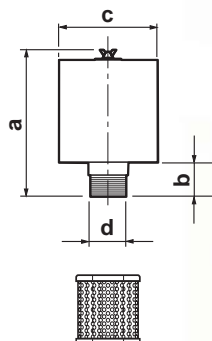

Suitable for	Item	a	b	c	d	Replacement Polyester cartridge	Replacement Paper cartridge
UNI-JET 40	168530	102	38,5	153	1"	167680	167681
UNI-JET 75/2V	168531	165	38,5	153	1 1/4"	167682	167683
TECNO-JET/2V	168532	165	38,5	153	1 1/2"	167682	167683
FLUX-JET/2V	168532	165	38,5	153	1 1/2"	167682	167683
UNI-JET 160	168532	165	38,5	153	1 1/2"	167682	167683
MEDIO-JET/2V	168533	184	57	254	2"	167684	167685
UNI-JET 500	168534	220	60	195	2 1/2"	—	167670
UNI-JET 1000/2V	168537	300	60	320	4"	—	167678