

TECNO-JET 2V

1,5 kW (50 Hz)
1,75 kW (60 Hz)

Del presente modello sono disponibili anche le seguenti versioni speciali:

This model is also available with the following specifications:

- **LUBRIFICATO** per alte temperature / **LHT** Lubrificated for higt temperature
- a richiesta **TENSIONI SPECIALI** / **SPECIAL VOLTAGES** on request

MOTORI COSTRUITI SECONDO LE NORME **CEI 2-3 (1988)** ISOL. **CL F** PROT. **IP 54**
 MOTORS CONSTRUCTION CONFORM WITH **CEI 2-3 (1988)** NORMS. ISOL. **CL F** PROT. **IP 54**

| ARTICOLO ITEM CODE | kW | V | Hz | assorb. AMP. absorbed. AMPS. | giri/min r.p.m. | LIMITE SERVIZIO MAX CONT. DUTY S1 mmH ₂ O | μF/V | dB (A)* | PESO Kg WEIGHT Kg |
|--|-----------------------|------|----------------|---------------------------------|--------------------|--|-------------|---------|----------------------|
| T R I P H A S E | 046950 | 1,5 | 230 Δ 400 Y | 50 | 6 3,5 | 2820 | -2500 +2500 | 65 | 25 |
| | | 1,75 | 265 Δ 460 Y | 60 | 6 3,5 | 3480 | -2700 +2350 | 68 | 25 |
| | 046952 LHT | 1,5 | 230 Δ 400 Y | 50 | 6 3,5 | 2820 | -3000 +2600 | 65 | 25 |
| | | 1,75 | 265 Δ 460 Y | 60 | 6 3,5 | 3480 | -2700 +2350 | 68 | 25 |

* Livello di pressione sonora rilevato secondo le Norme ISO 3746 - 1979 (E). Parametri: r=1 - Rumore di fondo ≤ 51 dB (A) - Strumento: Brüel & Kjær type 2232.
 * Sound pressure level tested according to ISO regulation 3746 - 1979 (E). Parameters: r=1 - Background noise ≤ 51 dB (A) - Instrument: Brüel & Kjær type 2232.

DIMENSIONI DIMENSIONS

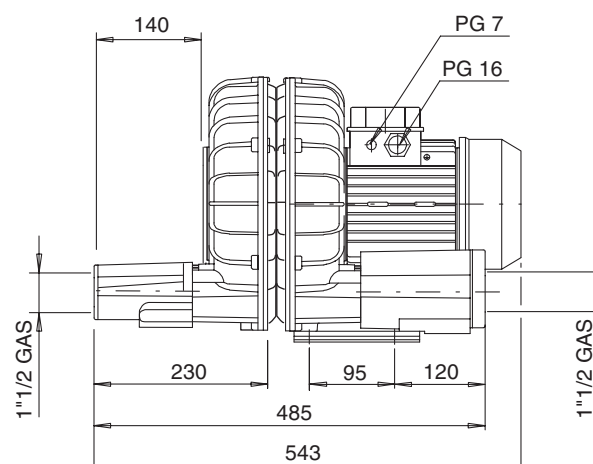
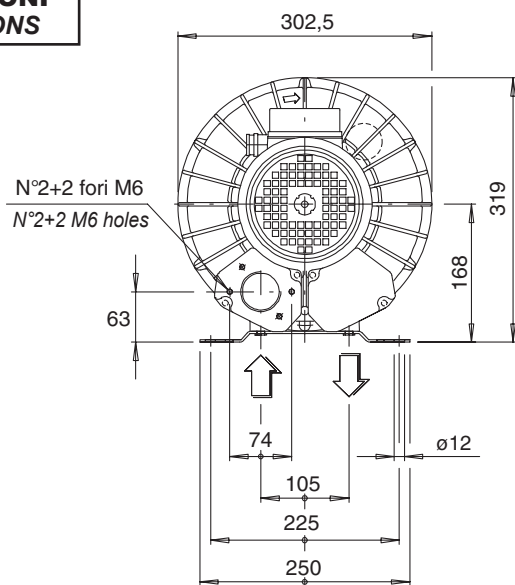

Le dimensioni di ingombro sono espresse in millimetri
 All dimensions are in mm.

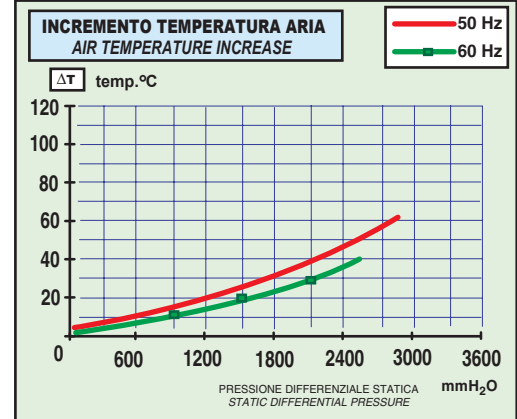
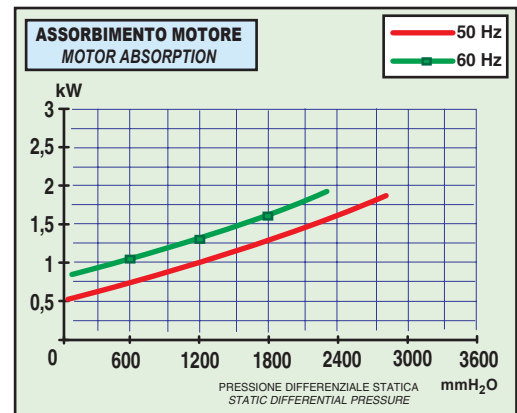
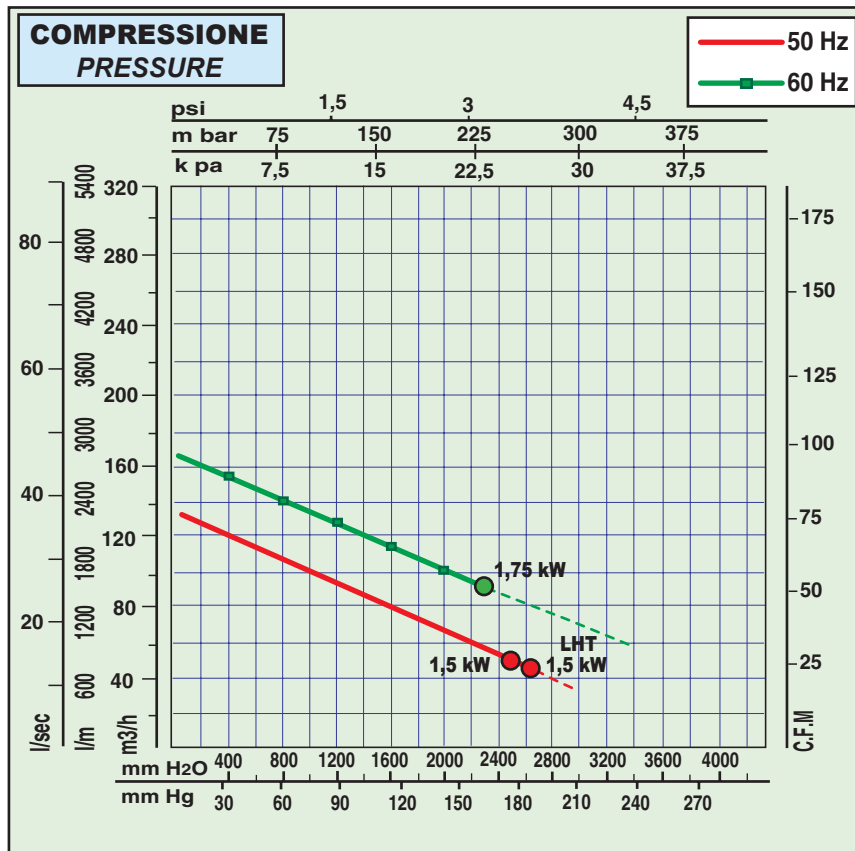
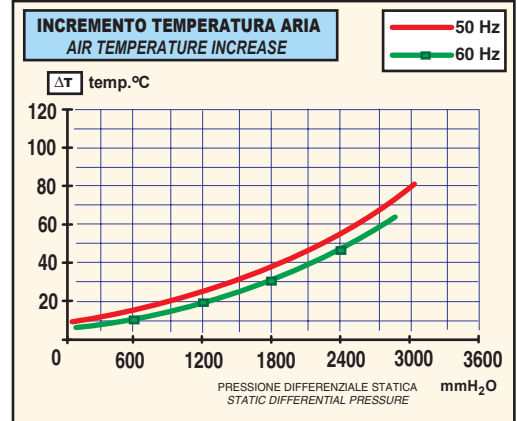
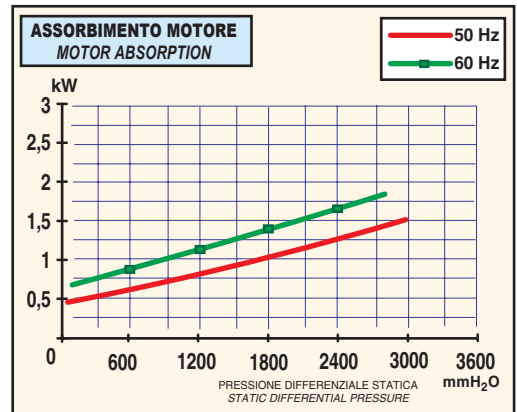
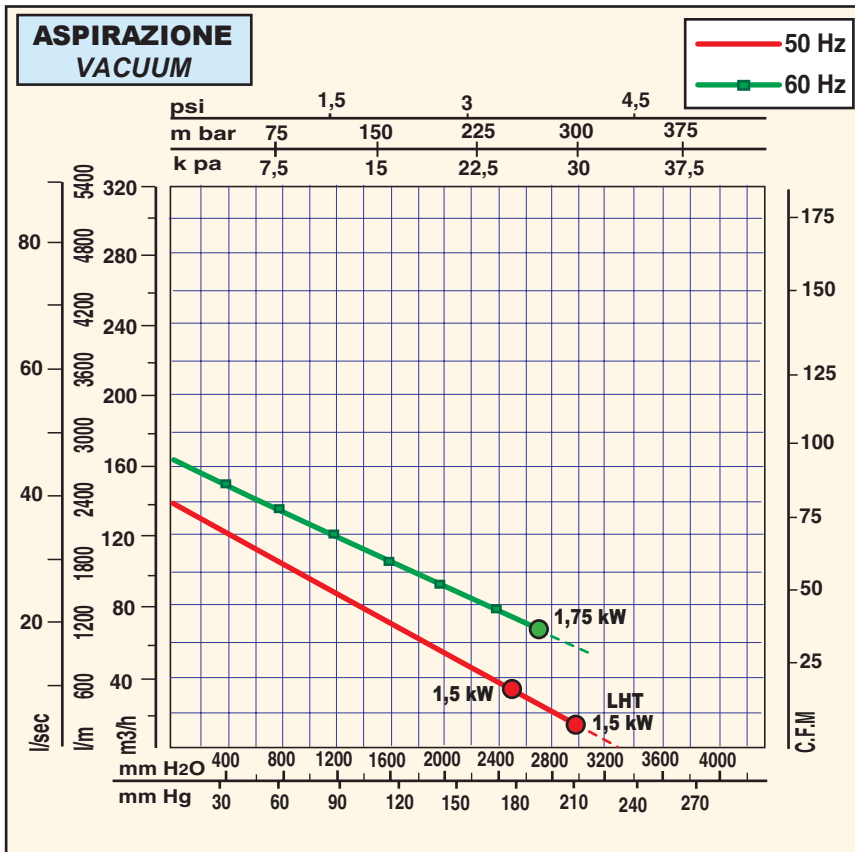

Tutti i dati della presente scheda tecnica si intendono indicativi e potranno essere modificati dalla casa in qualsiasi momento senza nessun preavviso.

La curva di aspirazione è riferita ad aria alla temperatura media di 20 °C e 1013 mbar sul raccordo di mandata.

La curva di compressione è riferita ad aria alla temperatura media di 20 °C e 1013 mbar sul raccordo di aspirazione.

All data is intended as an indication and may be modified without prior notice.

The vacuum curve is valid for pumping air, with a temperature of 20°C at the inlet flange and with a pressure of 1013 mbar at the discharge port.

The pressure curve is valid for pumping air, with an average temperature of 20°C and 1013 mbar at the inlet flange.

 Valore max di pressione per servizio continuativo
Max value for continuous duty